

Sous réserve de modifications techniques

autres informations techniques voir catalogue de produits et pièces détachées

Position des montants et des côtés

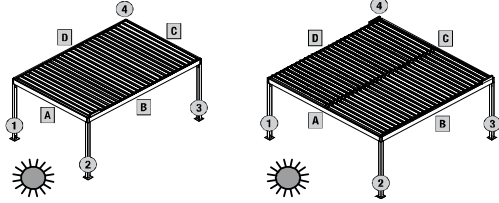

Lamelles ouvertes - fermées

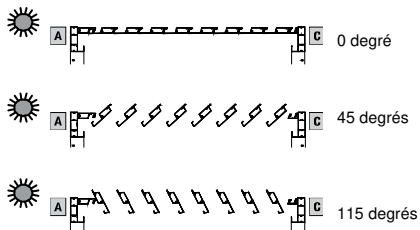

Positions d'entraînement possibles

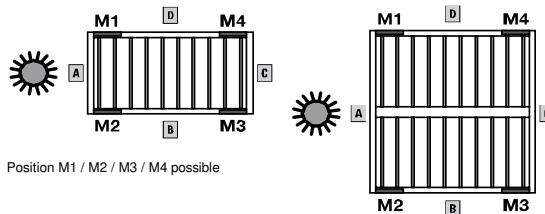

Position M1 / M2 / M3 / M4 possible

Position M1 + M2 ou M3 + M4 possible

Variantes de raccord mural

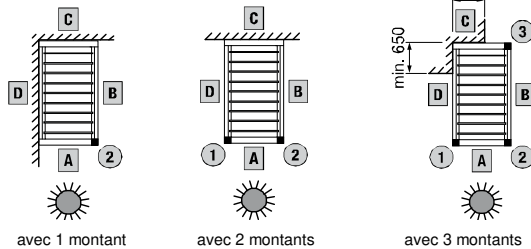

Vue B / D

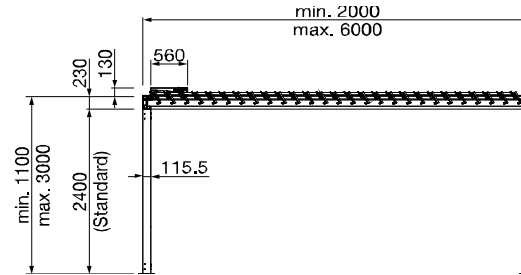

Vue A / C (installation simple)

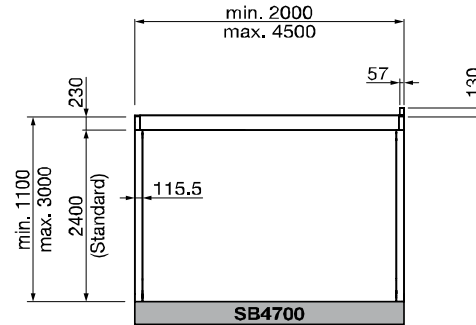

Vue A / C (installation double)

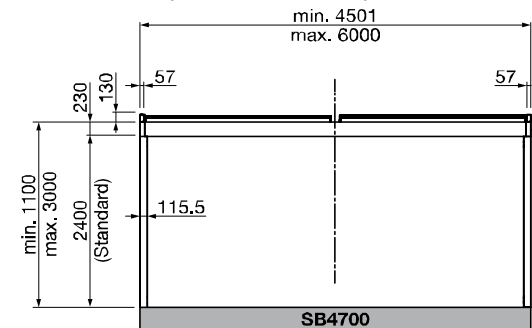

Plaques de base

TP313 (standard)

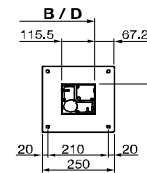

TP319 (angle)

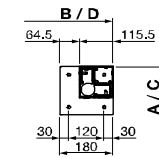

TP314 (plancher modulaire)

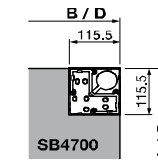

TP314-1 (garde-corps)

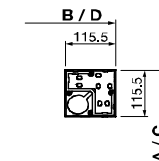

P5 et W5

impossible avec le plancher modulaire SB4700

Alimentation électrique / écoulement

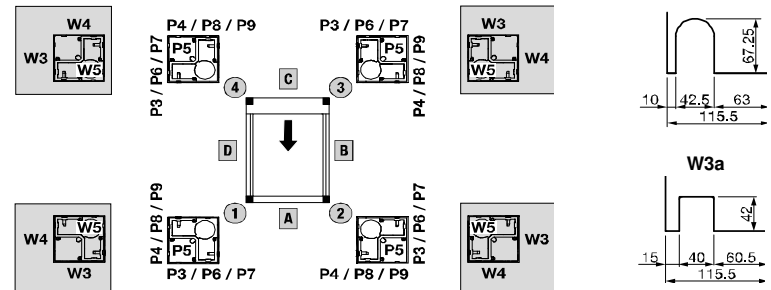

0 - 17 m² un écoulement nécessaire
17 - 36 m² deux écoulements nécessaires

